

**Boardwalk**

# St Nicholas Park

## EASTON

APPROXIMATE FLOOR AREA  
79.4 SQM / 855 SQFT

### BOOK A VIEWING

01174 532 985

[hello@boardwalkpropertyco.com](mailto:hello@boardwalkpropertyco.com)



GROUND FLOOR  
431 sq.ft. (40.0 sq.m.) approx.

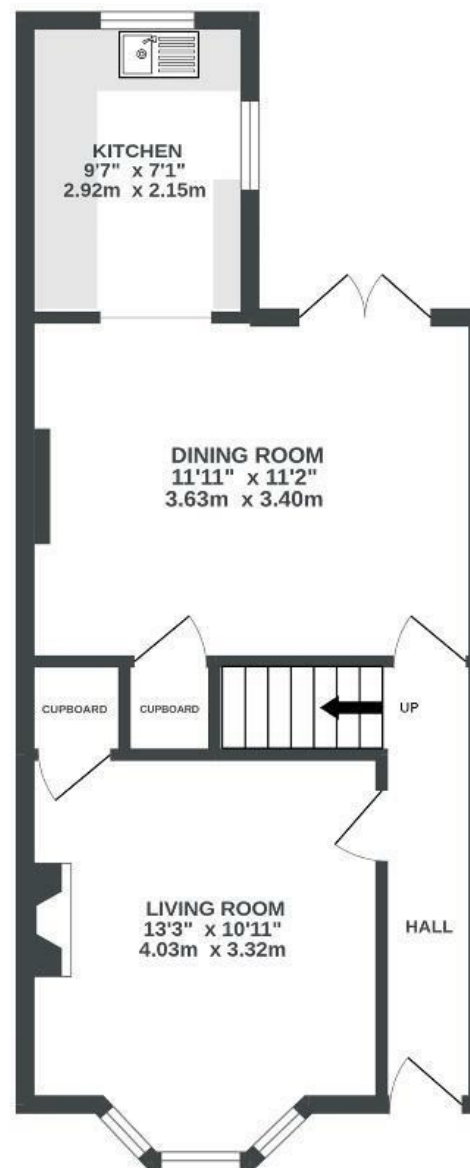

1ST FLOOR  
424 sq.ft. (39.4 sq.m.) approx.



Illustrations are for reference purposes only, measurements are approximate, not to scale.

Boardwalk

# St Nicholas Park

EASTON, BRISTOL



£335,000



2 Bedrooms



Bristol, BS5



1 Bathrooms

OTP

"We have loved living on St Nicholas Park and only wish we could take the community with us! The cul-de-sac is a sanctuary, with no through traffic it is very quiet and feels really safe. It naturally lends itself to a community who look out for one another: we feed one another's cats when we are away and have a group chat for tracing lost parcels and for those moments when you're in the middle of cooking and realise you don't have one of the ingredients!"

It was my first home in Bristol I shared with friends and then became a family home when I met my partner. Things I particularly love about the house are the skylights in the bathroom and staircase that make the house light all year round, and the garden space that feels very private and is great for relaxing and hosting. Being so close to the train station has also been a huge plus, making it easy to work in London when I need to. The proximity to St Marks Road, Sweetmart and the Bakery makes a Saturday morning mooch a must! And I love being close to Greenbank Cemetery and the Cycle path - two great greenspaces in Bristol."

